

## Side Menu

**Account Information** : your username is your Dynalink Photos account.

- Change profile picture.
- Change password.
- Verify email.
- Manage devices.
- Remove users (admin only).

1.The first registered account is the admin account. The admin can execute system related functions including factory reset, remove users, and format hard drive. Admin account is not able to view other users' photos & videos if they are located within a private space.

2.The email address for rescuing your password. If the email is not yet verified, the only solution is to reset your account through admin. All your data in private space will be deleted.



## External Drives

**Shows your plugged in external devices** such as an SD card or USB. **You can see photos/videos on external devices with Dynalink Photos.**

- 1.It would not display if no external devices were plugged in.
- 2.Support uploading photos/videos in external devices to Dynalink Photos. Do not support uploading to mobile devices.
- 3.Plugging in an external device does not add to the existing storage capacity of Dynalink Photos's storage.

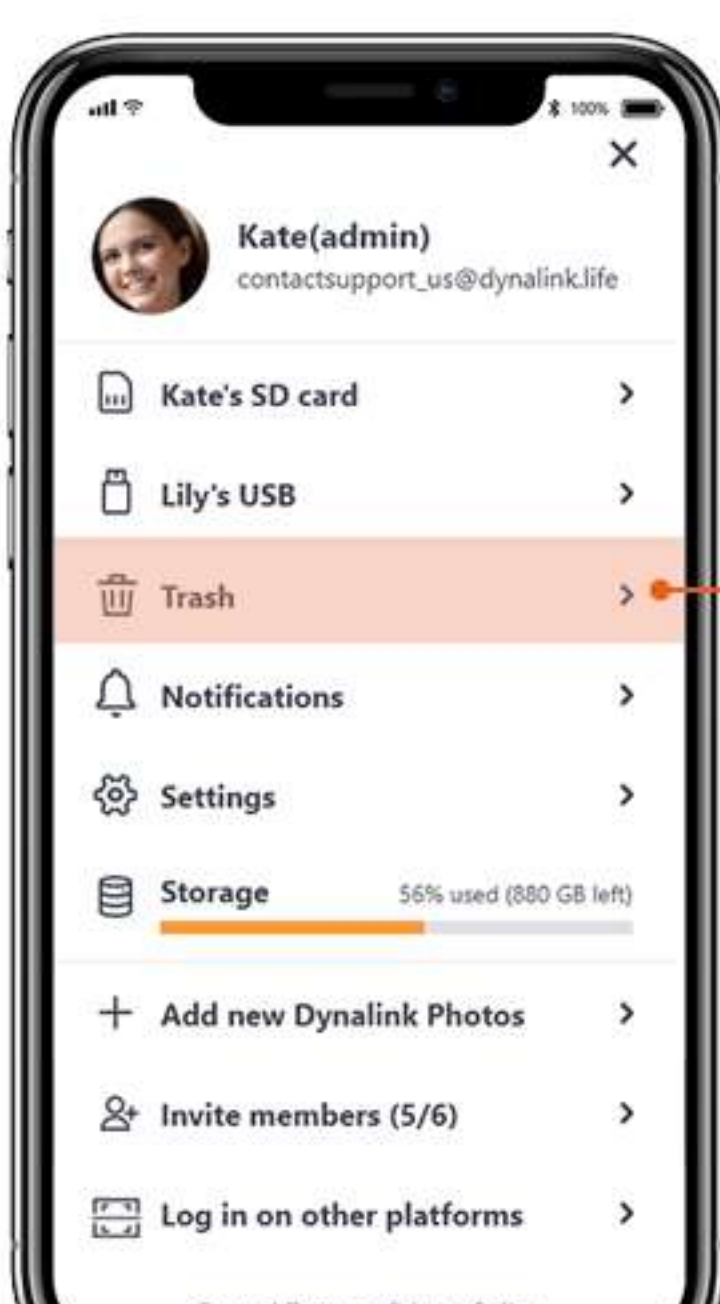

## Trash

**Check and restore the photo/video from the trash.**

1.The trash can occupies up to 3% of total storage. When the trash can is full, it automatically delete the previously deleted files to open up more space.

2.Trash can have a shared and private space. To ensure your privacy, your files in the private trash can will not be seen by other users.

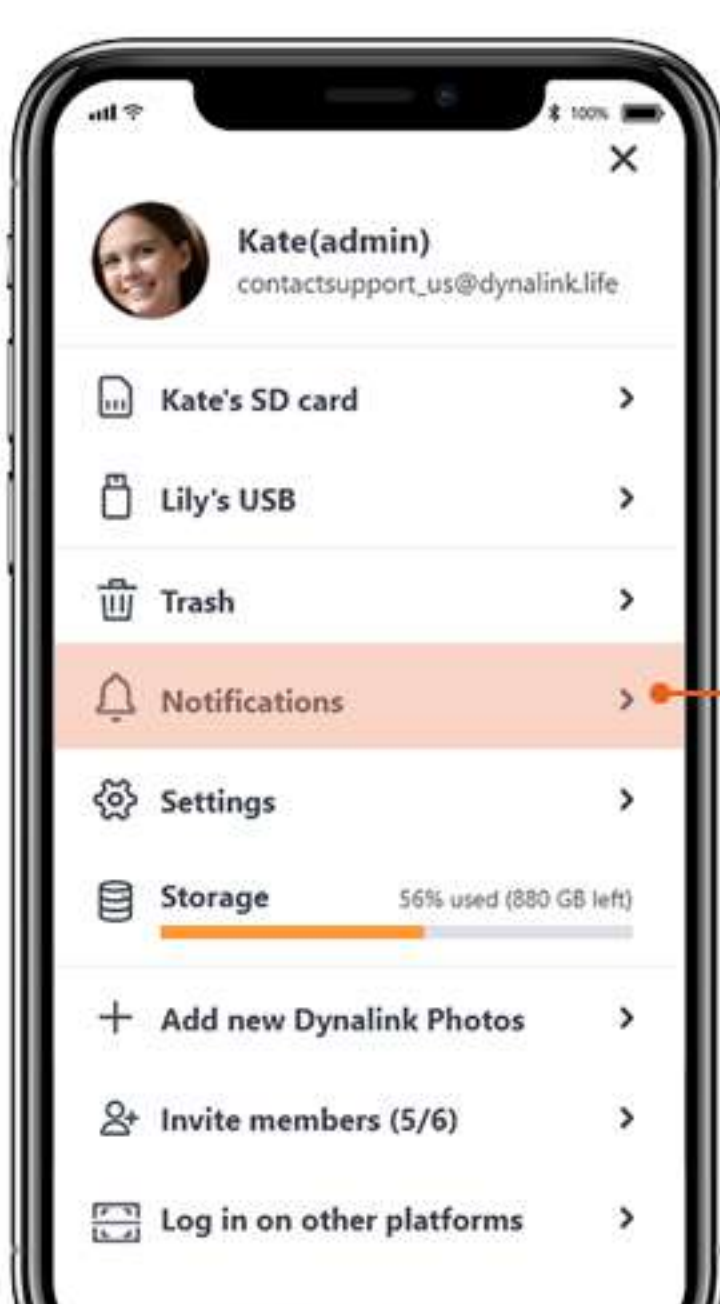

## Notifications

**Notification history.**

1.Display notifications from the past three months, including checking reminders and downloading notifications.

2.If the download notification is turned off, the system will not send download notifications when other users add new photos.

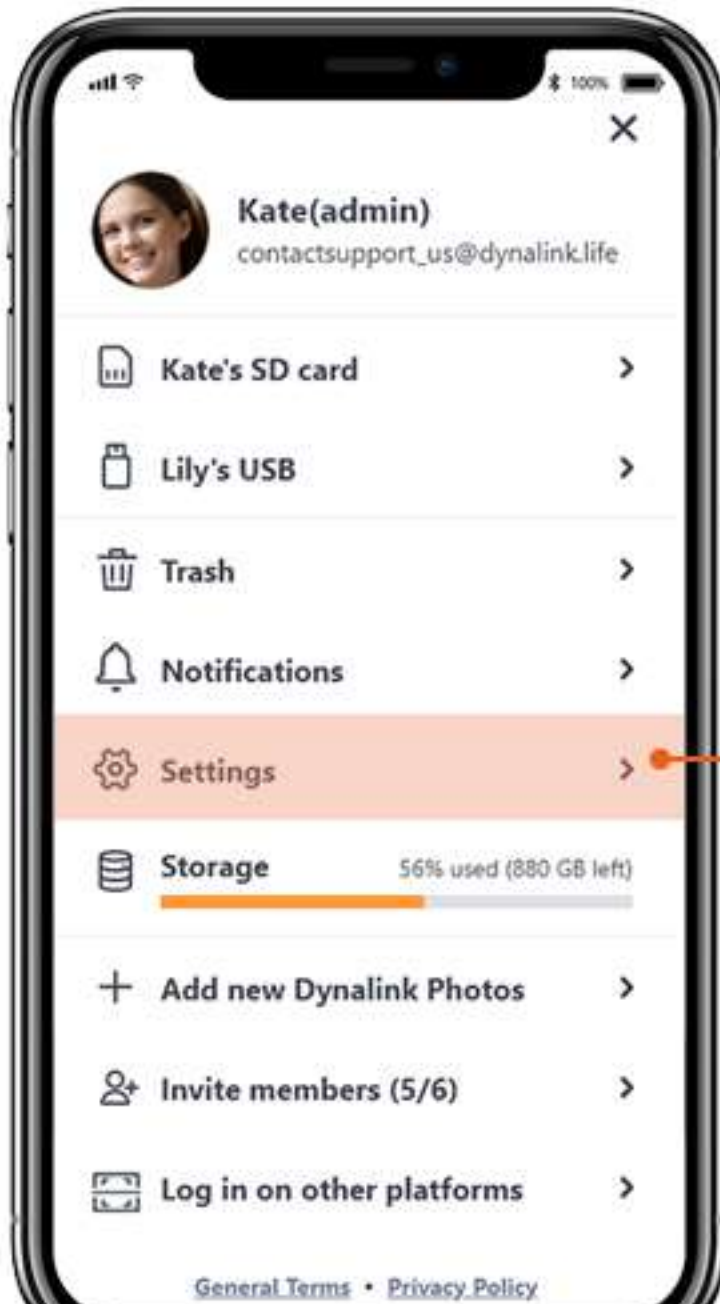

## Settings

- Optimize device storage.
- Preferences : automatic backup notifications, new photos download notifications.
- Export : export photos/videos.
- Advanced setting(admin only) : format hard drive, system update, factory reset.
- About : Dynalink Photos device version, IP number, Mac address, software version.

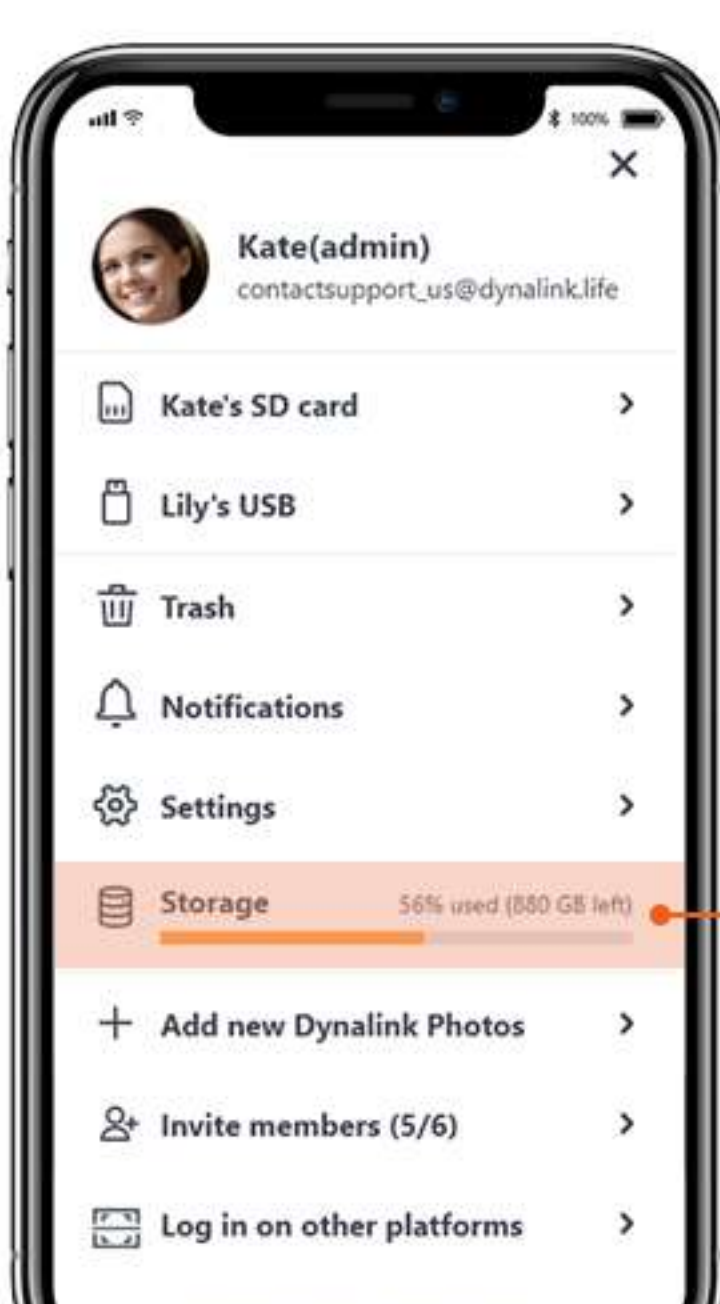

## Storage

**Current storage usage in Dynalink Photos. The admin account can see the usage distribution of Dynalink Photos.**

1.Find duplicates within the private space. After the execution is completed, you can review duplicate photos one by one or delete the older duplicates at once.

2.Find duplicates function needs time for CPU processing. Running this feature right before going to sleep during night is recommended.

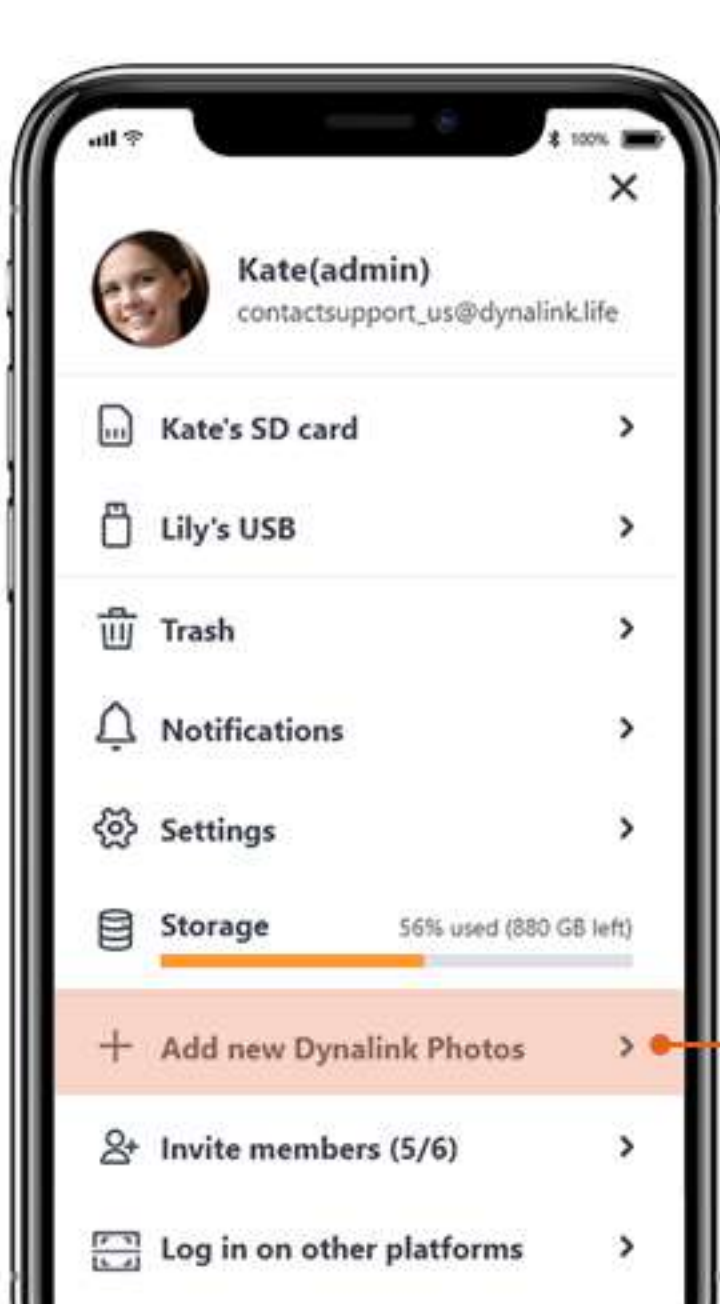

## Add New Dynalink Photos

**Connect to another Dynalink Photos device.**

- 1.Support two or more Dynalink Photos and connect to one at one time.
- 2.Switch to another device by selecting the name of Dynalink Photos you want to connect to.



## Invite Members

**To add new members, provide QR code for them to scan and join.**

- 1.Share a QR code with your family/friends in located outside your Wi-Fi network, so they can create a new account.
- 2.Anyone who has the QR code will be able to access. Share your QR code with caution.
- 3.One Dynalink Photos can share up to 6 users. Each user can log in up to 5 devices, including mobile devices, PC, and Google TV.
- 4.Dynalink Photos can log in up to 10 devices at the same time.



## Log In on Other Platforms

**Scan QR code on the platform you want to log in to.**

Logging on to Google TV or PC applications generates a QR code. Use this function to scan the QR code for quick login.